

AMMÁLI

ISLAND

A·M·A·L·I / أملي
'MY HOPES & DREAMS'

THE VISION OF AMALI

AMALI CREATES SEA-KISSED URBAN RESIDENCES THAT GO BEYOND THE ORDINARY AND REDEFINE THE CONCEPT OF LUXURY LIVING. WE CREATE REALMS THAT EPITOMISE SOPHISTICATION AND REFINEMENT, WORLDS WHERE FORM, FUNCTION AND FINESSE MEET IN PERFECT HARMONY.

THE VISIONARIES

In a world where luxury is often equated with excess, Ali and Amira Sajwani are on a journey to embrace exquisite simplicity with Amali.

Inspired by their father's spectacular track record in Dubai, the region and the world's high-end property development market, as well as their own experience at the helm of DAMAC Properties, Ali and Amira are dedicated to creating a new path for exceptional real estate.



As a trailblazing Emirati businesswoman, Amira Sajwani is known for her exacting standards of excellence, eye for design as well as an unerring commitment to quality.

At DAMAC Properties, Amira leads the firm's sales and development efforts in her capacity as Managing Director, and is hands-on throughout the property life-cycle, from design to construction, marketing and creative.

Amira is also the founder and CEO of PRYPKO, a revolutionary proptech platform that is steered by her tech expertise, innovation-led ethos and ability to forge key partnerships with agents, government authorities, global financial institutions and the community as a whole.



A serial Emirati entrepreneur with a knack for identifying opportunities others often miss, Ali Sajwani has made a name for himself as detail-oriented, digital-first leader.

Ali spearheads the digital transformation of DAMAC Properties as its Managing Director of Operations and Technology. To date, his efforts have been critical to the impressive expansion of the firm's growth, especially into new and untapped markets.

A great example of this is the Mandarin Oriental Resort in Maldives, a project he has led from inception, right through the development phase, helping extend DAMAC's hotel business into even more global markets.

PARTNERS OF AMALI:
OUR HANDPICKED ATELIER

AMALI IS MORE THAN JUST A LUXURY REAL ESTATE BRAND, AMALI IS A TEAM OF INTERNATIONAL AWARD WINNING DESIGNERS, ARCHITECTS, AND BUILDERS WHO ARE PASSIONATE ABOUT CRAFTING UNIQUE AND EXTRAORDINARY LIVING SPACES.



ARCHITECTURE

ELASTIC

ELASTIC is a global award-winning firm of international, diverse and talented architects and interior designers. Based in Athens, Greece with offices in London, Toronto, Dubai and Cyprus, the studio has an innovative approach that creates unique hospitality and lifestyle experiences.

ELASTIC brings their unrivalled understanding of fluidity, form and function to the architecture of Amali Islands, creating residences that effortlessly complement their beachfront environment via two distinct facades.

INTERIOR



Hirsch Bedner Associates has been shaping taste for the past 50 years and has delivered groundbreaking projects for developers and private clients across the world.

HBA Residential is the specialist design-house of HBA consisting of architects, interior designers and FF&E designers who conceive and develop beautifully crafted residential projects holistically.

Amali worked with HBA to conceptualise different interior aesthetics for the residences, each featuring carefully sourced materials from around the world.

LANDSCAPING



SquareM elevates landscaping to an art form, with an almost intuitive ability to craft refreshingly lush environments.

The firm is renowned for painstakingly researching the natural parameters of a space, sourcing both indigenous as well as exotic species of plants and bringing them together in the most sustainable way possible.

Amali collaborated with SquareM to design oases with calm, inimitable sanctuaries of rejuvenation.

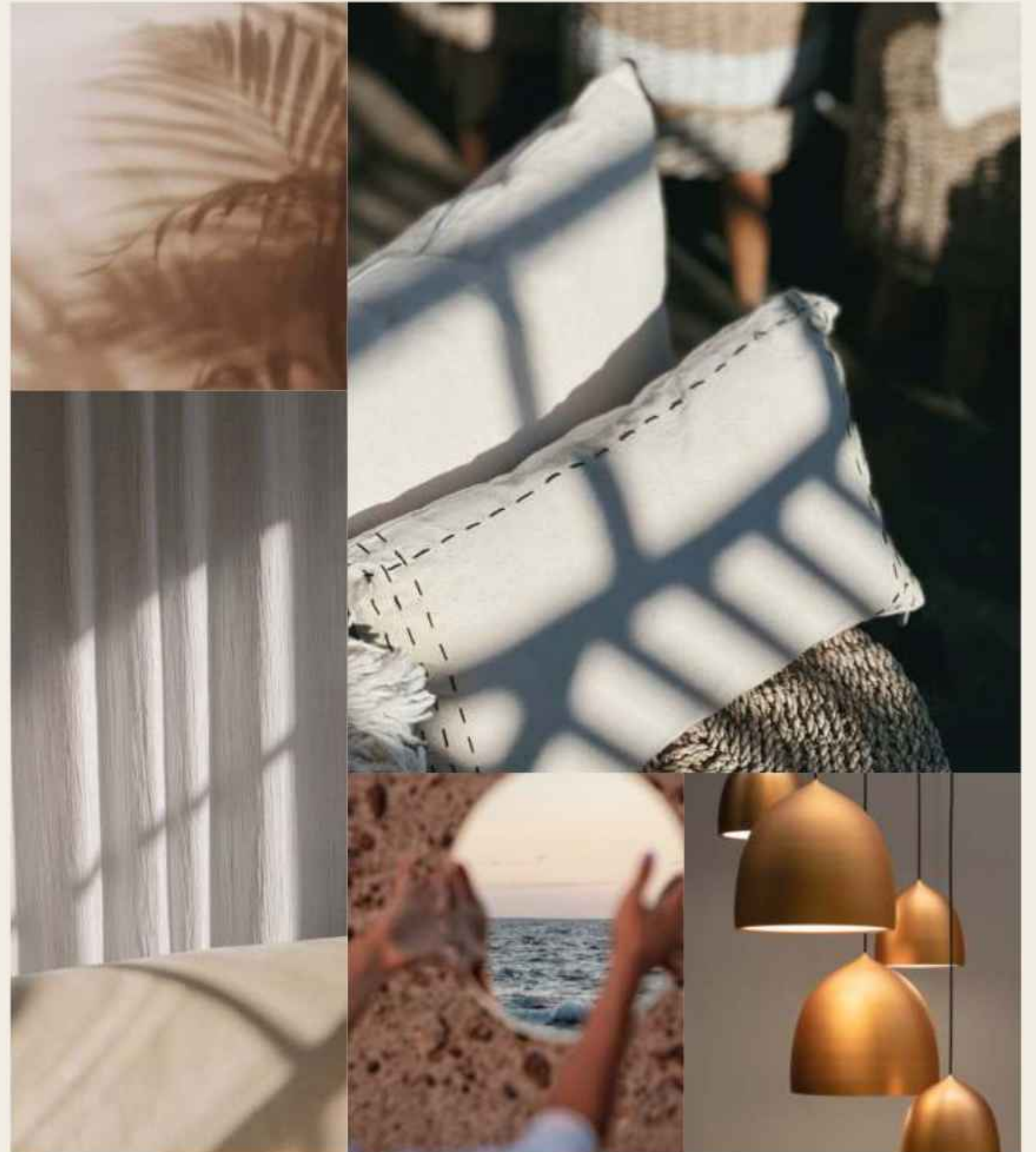



IN A WORLD OF EXCESS, WE CONJURE *sophistication*



IN A TIME OF CHAOS, WE CELEBRATE *harmony*



IN A REALM OF DESIRE, WE ARE THE *hope*



REDEFINING LUXURY LIVING,
ONE DREAM AT A TIME.

AMALI

Islands

STEP INTO A REALM OF PERPETUAL VACATION,
WHERE EVERY RETURN HOME CONJURES THE SENSATION
OF EMBARKING ON A BLISSFUL HOLIDAY.

WELCOME HOME TO YOUR PRIVATE ISLAND





THE WORLD ISLANDS

VIEW TO
DUBAI SKYLINE

SAO PAULO

URUGUAY

MADINAT JUMERIAH - 9 MINS

JUMERIAH - 7 MINS

DEIRA - 11 MINS

DUBAI

COUTURE



7 MINS

MAINLAND DUBAI



22 MINS

DUBAI INTERNATIONAL
AIRPORT



9 MINS

PALM JUMEIRAH



24 MINS

JETEX PRIVATE
TERMINAL



14 MINS

DOWNTOWN DUBAI



17 MINS

DIFC



7 MINS

PRIVATE WHARVES



10 MINS

CAVALLI COUTURE
MAIN PARKING



7 MINS

VEGAS INSPIRED
ISLAND

MASTERPLAN AT A GLANCE

AMALI ISLAND CONNECTS TWO OF THE WORLD ISLANDS, A FEAT OF HUMAN ENGINEERING THAT IS ONE OF THE WORLD'S MOST ICONIC DEVELOPMENTS.



- VILLA AVATEA
- VILLA ARIA
- VILLA AURORA
- VILLA AMORINO
- RESIDENTS CLUBHOUSE

PALM JUMEIRAH AND THE ROYAL ATLANTIS VIEW

670,354 SQFT

TOTAL AREA OF AMALI ISLAND

24

EXCLUSIVE RESIDENCES

360° VIEWS

OF SEA, DUBAI SKYLINE AND PALM JUMEIRAH

50M

UP TO 50 METRES OF PRIVATE BEACHFRONT

AMENITIES

RESTAURANT, FITNESS CENTER, SPA & CONCIERGE

PRIVATE BERTHS

AT EACH BEACHFRONT VILLA FOR EASY ACCESS

CLUBHOUSE

MEMBERS-ONLY CLUBHOUSE

HELIPAD

EXCLUSIVELY FOR RESIDENTS



THE INSPIRATION

ON SOUTH AMERICA'S GRASSLANDS, THE PAMPAS, THERE IS A TREE EMBLEMATIC OF THE REGION'S RICH CULTURAL HERITAGE AND PASSION FOR THE ENVIRONMENT - THE OMBU.

THE SEEMINGLY HUMBLE TREE, KNOWN FOR ITS SHELTERING CANOPY, IS ROOTED IN A PHILOSOPHY OF SANCTUARY AND WISDOM THAT INSPIRED OUR ATELIER WHEN ENVISIONING AMALI ISLANDS.

FEATURES THAT
MAKE A HOME

NESTLED ON THE SHORES OF THE ISLANDS ARE PRIVATE BERTHS, ALONG WITH AN EXCLUSIVE CLUBHOUSE, SPA, CUTTING-EDGE FITNESS CENTER AND TRANQUIL, TREE-LINED PATHWAYS TO INSPIRE REJUVENATION.





NEW VILLAS ISLAND





A NAUTICAL NIRVANA

STEPS AWAY FROM EACH VILLA, NESTLED ON PRISTINE ISLAND SHORES, IS ITS STATE-OF-THE-ART PRIVATE BERTH.

STEEPED IN EXCLUSIVITY, THESE BERTHS ACCOMMODATE A VARIETY OF MOTOR AND SAILING YACHTS, INCLUDING THE PRESTIGIOUS RIVA RIVARAMA 44.

BELOVED BY SILVER SCREEN SIRENS AS WELL AS ROYALTY, THE RIVA RIVARAMA 44 IS AN ERA-DEFINING VESSEL THAT RESIDENTS OF AMALI ISLANDS ARE INVITED TO OWN ON PURCHASE OF A VILLA.



LUXURY LIVING, HOWEVER YOU DREAM IT

OUR 4 VILLA TYPOLOGIES RISE FROM THE SHORE IN EITHER 'GRANDE' OR 'MINIMA' STYLES WITH...

2 TRIBES OF INTERIOR TEXTURES

AMALI ISLANDS CREATES TWO UNIQUE ISLAND HOME ENVIRONMENTS TO CHOOSE FROM, WHERE INDIVIDUALS CAN EXPRESS THEIR PERSONAL STYLE AND CREATE A CUSTOMISED INTERIOR DESIGN FROM MODERN TO CLASSIC TONES.

Terra

Ultra

MODERN, SUBTLE AND EARTHY HUES.

OPULENCE, EXTRAVAGANCE AND CLASSIC TONES.







AVATEA GRANDE ISLAND

An architectural rendering of a modern villa named 'Avatea'. The building features a prominent central entrance with a large, cantilevered roof supported by two thick columns. The facade is composed of light-colored concrete or stone, with sections of perforated metal screens. The villa is surrounded by lush tropical landscaping, including numerous palm trees and various green plants. The sky is a soft, hazy blue, suggesting a late afternoon or early morning setting. The overall aesthetic is clean, minimalist, and sophisticated.

VILLA

Avatea

MORE DETAILS ON REQUEST

VILLA
Aria

GRANDE



An architectural rendering of a modern, multi-story villa named 'Villa Aria'. The building features a symmetrical design with two main wings, each with a prominent, rounded, cantilevered upper level. Large glass windows and balconies are visible, reflecting the surrounding tropical environment. The villa is set in a lush courtyard with several tall palm trees and various tropical plants. In the foreground, there are two rectangular outdoor seating areas with cushions, flanking a central stone walkway. The overall atmosphere is warm and sophisticated, with a color palette dominated by earthy tones and greens.

VILLA
Aria

MORE DETAILS ON REQUEST

VILLA
Aurora

GRANDE





AMALI ISLAND

AURORA GRANDE // AERIAL VIEW



MAVATI ISLAND



ISLAND



AURORA GRANDE / AERIAL VIEW

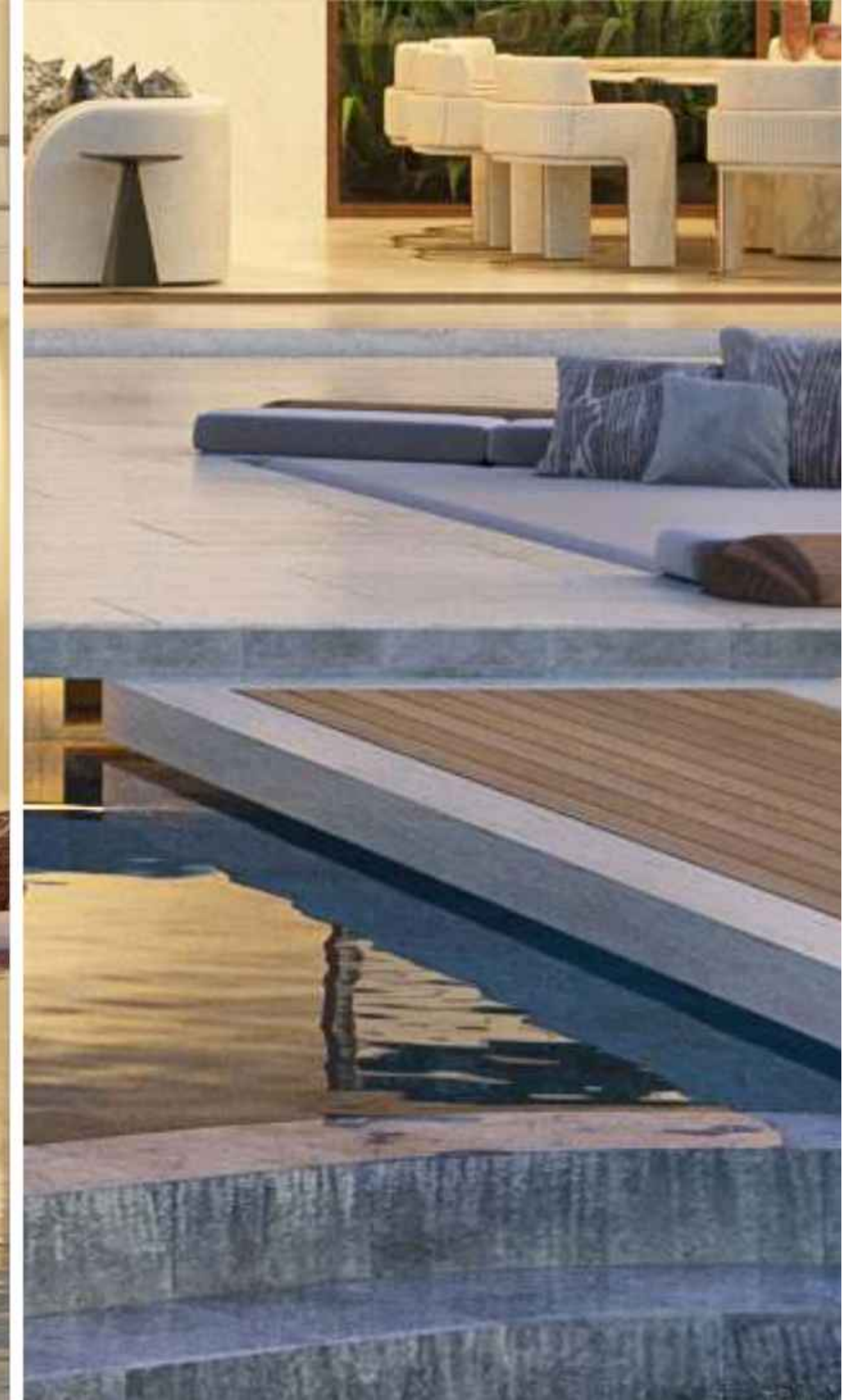
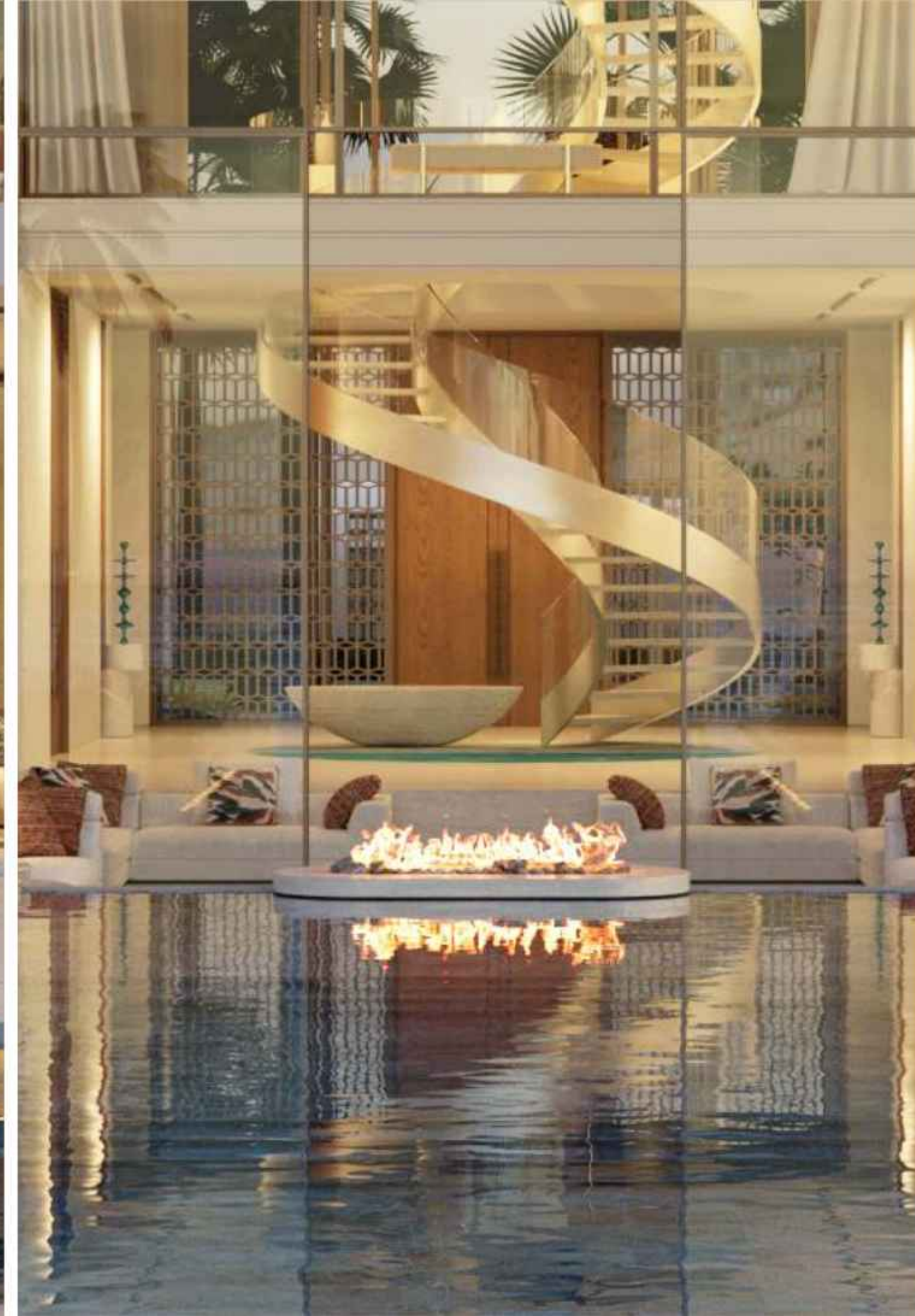

VILLA AURORA CREATES TWO UNIQUE ISLAND HOME ENVIRONMENTS TO CHOOSE FROM,
WHERE INDIVIDUALS CAN EXPRESS THEIR PERSONAL STYLE AND CREATE
A CUSTOMISED INTERIOR DESIGN FROM MODERN TO CLASSIC TONES.

INTRODUCING

Terra

MODERN, SUBTLE AND EARLTHY HUES.







SLAND







AMATI ISLAND



AURORA DINING / TERRA



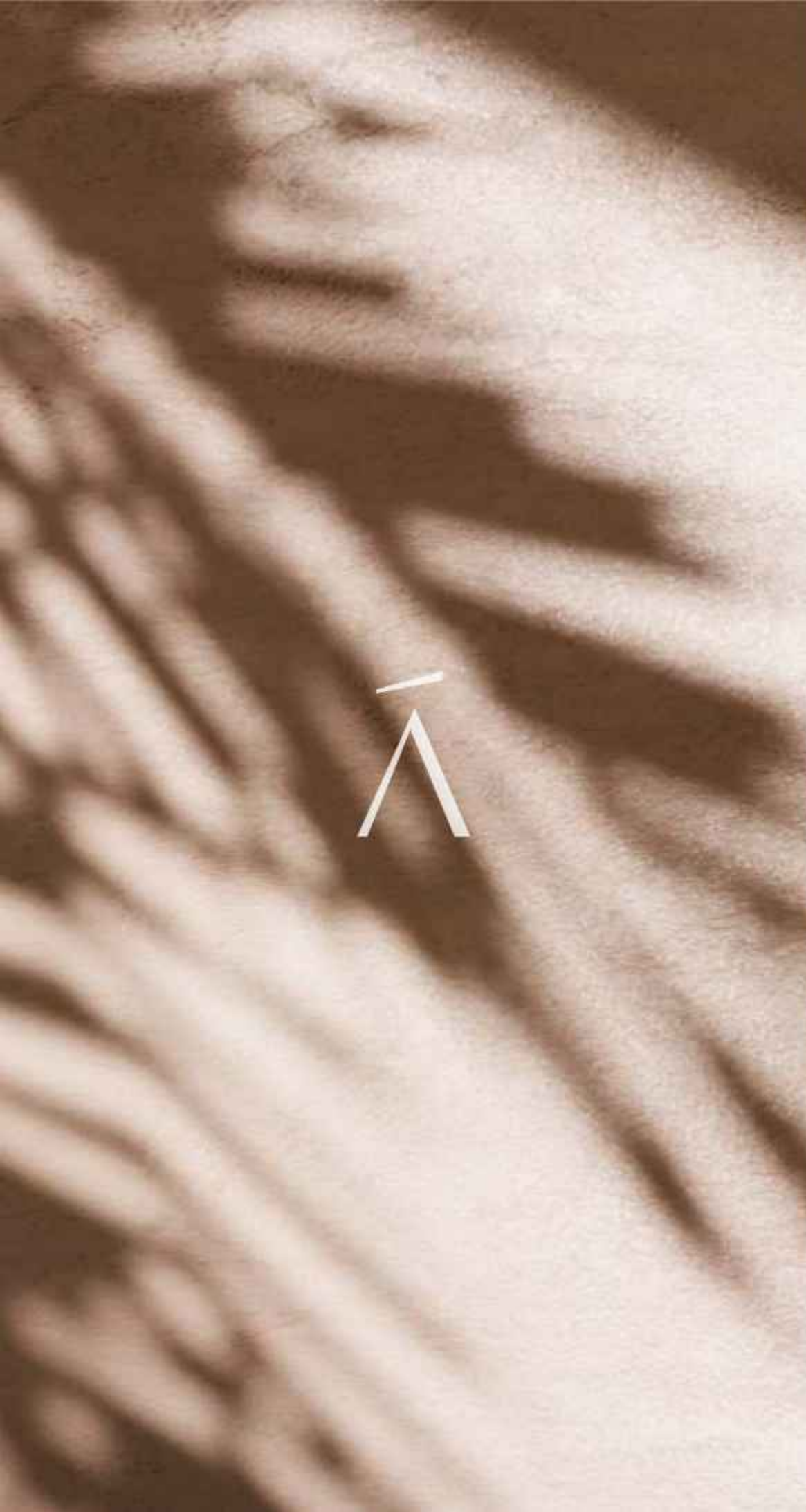



AMALI ISLAND





ISLAND



VILLA AURORA HAS A SECOND UNIQUE ISLAND HOME ENVIRONMENT
TO CHOOSE FROM, CONSISTS OF CLASSIC AND MORE TRADITIONAL LUXURY TONES.

INTRODUCING

Ultra

OPULENCE, EXTRAVAGANCE AND CLASSIC TONES.







ISLAND





ISLAND
COMFORT



AURORA DINING / ULTRA





AMALI ISLAND





AMALI ISLAND



VILLA
Amorino

GRANDE



VILLA AMORINO CREATES TWO UNIQUE ISLAND HOME ENVIRONMENTS TO CHOOSE FROM,
WHERE INDIVIDUALS CAN EXPRESS THEIR PERSONAL STYLE AND CREATE
A CUSTOMISED INTERIOR DESIGN FROM MODERN TO CLASSIC TONES.

INTRODUCING

Terra

MODERN, SUBTLE AND EARLTHY HUES.







NEW ISLAND





SLAYD
MAY 2024



VILLA AMORINO'S SECOND UNIQUE ISLAND HOME ENVIRONMENT
TO CHOOSE FROM, CONSISTS OF CLASSIC AND MORE TRADITIONAL LUXURY TONES.

INTRODUCING

Ultra

OPULENCE, EXTRAVAGANCE AND CLASSIC TONES.











SLAB





AMALI ISLAND

"EACH AMALI ISLANDS HOME BLURS THE LINES BETWEEN NATURAL OPULENCE AND CONTEMPORARY SOPHISTICATION."

Ali Sajwani



LUXURY LIVING REDEFINED,
ONE DREAM AT A TIME.





TANAMI
P R O P E R T I E S

CONTACT US

 +971 4 248 3400 |  +971 55 162 3236

Email Us

info@tanamiproperties.ae

For More Info...

www.tanamiproperties.com/Projects/Amali-Island-Villas



ADDRESS

Office 3405, Marina Plaza,
Al Marsa Street, Dubai Marina, UAE